

阳山县阳城镇2013年度第五批次城镇建设用地平面图

2704.582-363.784

2705.182-2705.182	2705.182	2705.182	2705.182
-362.984	-363.784	-364.584	-364.584
2704.582	2704.582	2704.582	2704.582
-362.984	-364.584	-364.584	-364.584
2703.982	2703.982	2703.982	2703.982
-362.984	-363.784	-364.584	-364.584

点号	X	Y	边长
J1	2704783.010	364101.140	350.23
J2	2705023.555	364355.702	85.94
J3	2705082.802	364418.142	133.78
J4	2704977.554	364500.973	5.95
J5	2704972.883	364504.657	33.53
J6	2704946.553	364525.418	20.01
J7	2704937.777	364507.434	20.43
J8	2704928.647	364489.153	5.62
J9	2704926.196	364484.096	5.78
J10	2704923.388	364479.038	62.31
J11	2704892.738	364424.789	66.37
J12	2704857.258	364368.698	52.98
J13	2704829.903	364323.332	117.95
J14	2704765.931	364224.237	27.12
J15	2704750.659	364201.830	25.00
J16	2704737.272	364180.713	32.58
J17	2704719.847	364153.190	31.72
J18	2704702.880	364125.390	34.55
J19	2704730.410	364105.520	36.05
J20	2704759.430	364084.130	2.99
J21	2704762.060	364083.080	1.31
J22	2704763.370	364083.080	2.00
J23	2704764.950	364084.310	22.50
J24	2704780.540	364100.440	1.27
J25	2704781.700	364101.140	1.31
J1	2704783.010	364101.140	
S=55928.24 平方米 83.8924亩			

点号	X	Y	边长
J1	2704723.162	364028.048	55.75
J2	2704757.415	364072.036	5.38
J3	2704760.265	364076.596	7.50
J4	2704759.125	364084.007	27.19
J5	2704736.324	364098.827	20.24
J6	2704719.223	364109.658	4.56
J7	2704714.662	364109.658	5.26
J8	2704710.672	364106.238	50.55
J9	2704685.591	364062.346	12.18
J10	2704678.573	364052.391	16.98
J11	2704693.560	364044.410	29.45
J12	2704719.290	364030.090	4.38
J1	2704723.162	364028.048	
S=3583.90 平方米 5.5259亩			

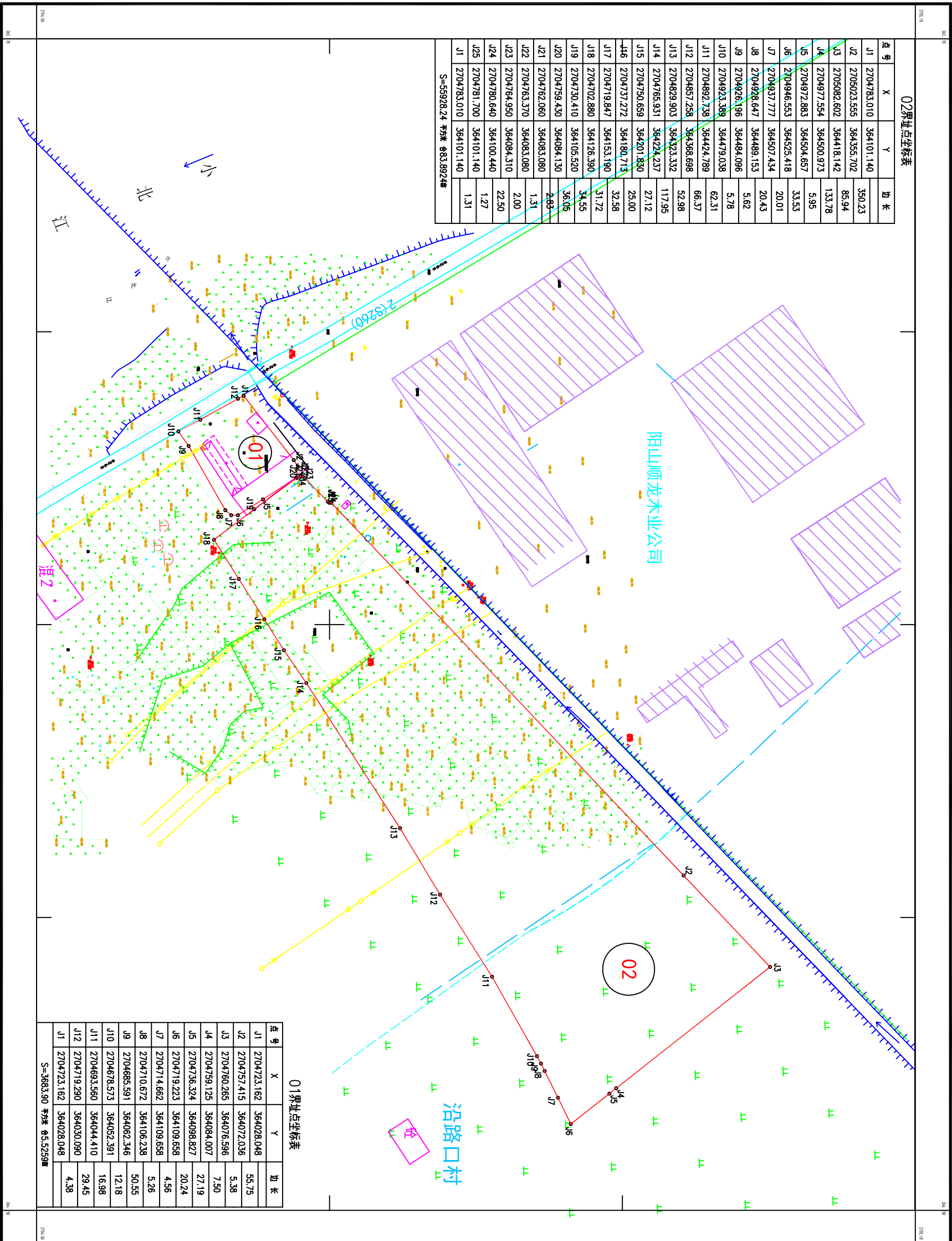

阳山县国土测绘队

1980西安坐标系,1985国家高程基准,等高距为米  
GB/T20257.1-2007国家基本比例尺地图式  
1:500地形图图式  
阳山县国土测绘队于2013年07月测制

